

# D921

single  
mechanical  
seal

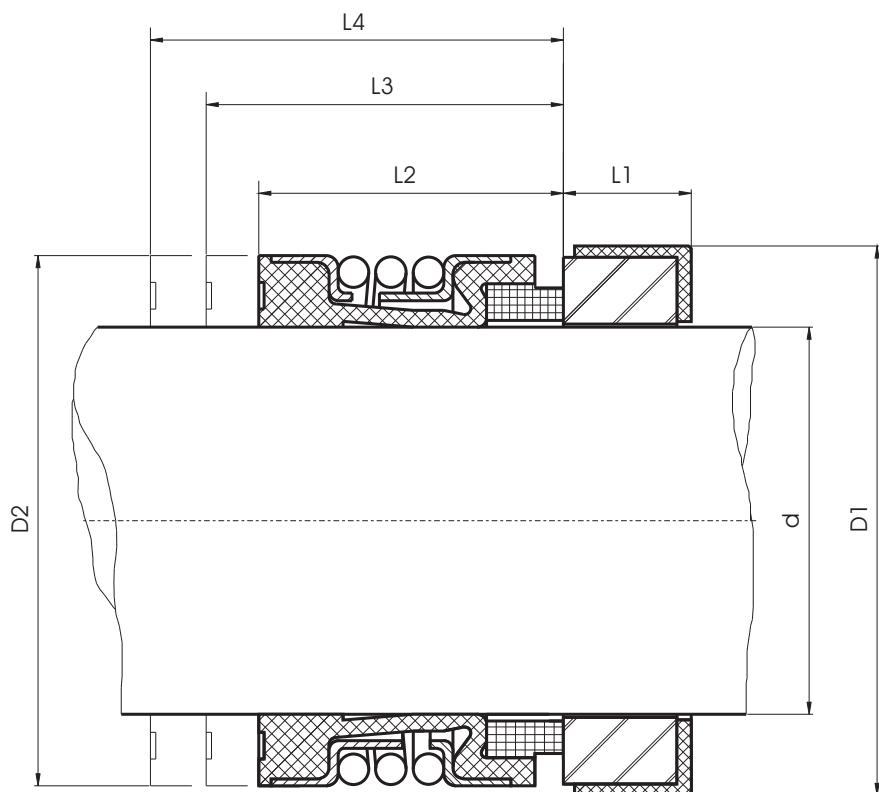

(mm)

## BASIC DIMENSIONS

d <sub>B</sub>	D	D1	L1	L2	L3	L4
10	20	21	5	15	27,5	35,0
12	22	23	6	15	26,5	34,0
14	24	25	6	15	29,0	34,0
15	25	26	6	15	29,0	34,0
16	26	27	6	15	29,0	34,0
18	32	33	6	20	31,5	39,0
20	34	35	6	20	31,5	39,0
22	36	37	6	20	31,5	39,0
24	38	39	6	20	34,0	44,0
25	39	40	6	20	34,0	44,0
28	42	43	6	26	36,5	44,0
30	44	45	7	26	35,5	43,0
32	46	48	7	26	35,5	48,0
33	47	48	7	26	35,5	48,0
35	49	50	8	26	34,5	47,0
38	54	56	8	30	37,0	47,0
40	56	58	8	30	37,0	47,0
43	59	61	8	30	37,0	52,0
45	61	63	8	30	37,0	52,0
48	64	66	10	30	35,0	50,0
50	66	70	10	30	37,5	50,0
53	69	73	10	30	37,5	60,0
55	71	75	10	30	37,5	60,0
58	78	78	10	33	42,5	60,0
60	80	80	12	33	40,5	58,0
63	83	83	12	33	40,5	58,0
65	85	85	12	33	40,5	68,0
68	88	90	12	33	40,5	68,0
70	90	92	12	33	48,0	68,0
75	99	97	12	40	48,0	68,0
80	104	105	14	40	47,5	77,5
85	109	110	14	40	47,5	77,5
90	114	115	14	40	52,5	77,5
95	119	120	14	40	52,5	77,5
100	124	125	14	40	52,5	77,5

(inch)

d <sub>B</sub>	D	D1	L1
0,375	0,787	0,875	0,591
0,500	0,945	1,000	0,591
0,625	1,024	1,250	0,591
0,750	1,260	1,375	0,787
0,875	1,417	1,500	0,787
1,000	1,535	1,625	0,787
1,125	1,654	1,750	1,024
1,250	1,811	1,875	1,024
1,375	1,929	2,000	1,024
1,500	2,126	2,125	1,181
1,625	2,205	2,375	1,181
1,750	2,402	2,500	1,181
1,875	2,520	2,625	1,181
2,000	2,598	2,750	1,181
2,125	2,717	3,000	1,181
2,250	3,031	3,125	1,299
2,375	3,150	3,250	1,299
2,500	3,268	3,375	1,299
2,625	3,465	3,375	1,299
2,750	3,504	3,500	1,299
2,875	3,780	3,750	1,299
3,000	3,898	3,875	1,575
3,125	4,055	4,000	1,575
3,250	4,094	4,125	1,575
3,375	4,252	4,250	1,575
3,500	4,409	4,375	1,575
3,625	4,488	4,500	1,575
3,750	4,646	4,625	1,575
3,875	4,803	4,750	1,575
4,000	4,882	4,875	1,575

### NOTES:

- Permissible installing deviations of the L dimension up to +/- 1 mm.

# D921

единично

механично

уплътнение

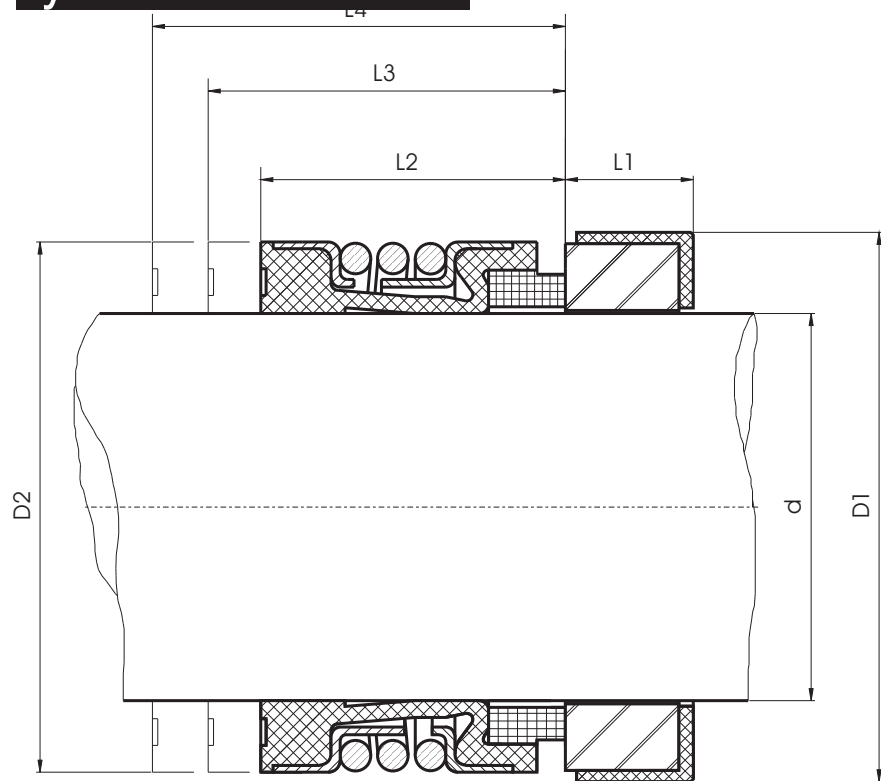

## ОСНОВНИ РАЗМЕРИ

(mm)

$d_B$	D	D1	L1	L2	L3	L4
10	20	21	5	15	27,5	35,0
12	22	23	6	15	26,5	34,0
14	24	25	6	15	29,0	34,0
15	25	26	6	15	29,0	34,0
16	26	27	6	15	29,0	34,0
18	32	33	6	20	31,5	39,0
20	34	35	6	20	31,5	39,0
22	36	37	6	20	31,5	39,0
24	38	39	6	20	34,0	44,0
25	39	40	6	20	34,0	44,0
28	42	43	6	26	36,5	44,0
30	44	45	7	26	35,5	43,0
32	46	48	7	26	35,5	48,0
33	47	48	7	26	35,5	48,0
35	49	50	8	26	34,5	47,0
38	54	56	8	30	37,0	47,0
40	56	58	8	30	37,0	47,0
43	59	61	8	30	37,0	52,0
45	61	63	8	30	37,0	52,0
48	64	66	10	30	35,0	50,0
50	66	70	10	30	37,5	50,0
53	69	73	10	30	37,5	60,0
55	71	75	10	30	37,5	60,0
58	78	78	10	33	42,5	60,0
60	80	80	12	33	40,5	58,0
63	83	83	12	33	40,5	58,0
65	85	85	12	33	40,5	68,0
68	88	90	12	33	40,5	68,0
70	90	92	12	33	48,0	68,0
75	99	97	12	40	48,0	68,0
80	104	105	14	40	47,5	77,5
85	109	110	14	40	47,5	77,5
90	114	115	14	40	52,5	77,5
95	119	120	14	40	52,5	77,5
100	124	125	14	40	52,5	77,5

(inch)

$d_B$	D	D1	L1
0,375	0,787	0,875	0,591
0,500	0,945	1,000	0,591
0,625	1,024	1,250	0,591
0,750	1,260	1,375	0,787
0,875	1,417	1,500	0,787
1,000	1,535	1,625	0,787
1,125	1,654	1,750	1,024
1,250	1,811	1,875	1,024
1,375	1,929	2,000	1,024
1,500	2,126	2,125	1,181
1,625	2,205	2,375	1,181
1,750	2,402	2,500	1,181
1,875	2,520	2,625	1,181
2,000	2,598	2,750	1,181
2,125	2,717	3,000	1,181
2,250	3,031	3,125	1,299
2,375	3,150	3,250	1,299
2,500	3,268	3,375	1,299
2,625	3,465	3,375	1,299
2,750	3,504	3,500	1,299
2,875	3,780	3,750	1,299
3,000	3,898	3,875	1,575
3,125	4,055	4,000	1,575
3,250	4,094	4,125	1,575
3,375	4,252	4,250	1,575
3,500	4,409	4,375	1,575
3,625	4,488	4,500	1,575
3,750	4,646	4,625	1,575
3,875	4,803	4,750	1,575
4,000	4,882	4,875	1,575

### ЗАБЕЛЕЖКИ

■ Допустими монтажни отклонения на размера L - го +/- 1 мм.